

## Warranty



To receive after-Sale service, have the following ready when you contact our branches

1. Name of the product
2. Model number of the product
3. The area of problem
4. Phone number and address at which you can be contacted.

## Warranty Card

PRODUCT	
MODEL	
DATE PURCHASED	
WARRANTY PERIOD	
AGENCY ADDRESS	

### ■ KOCOM Warranties the original purchaser of this product as follows.

- 1) This product is produced under strict quality control and inspection procedures.
- 2) If this product breaks down during proper use as a result of product defect, KOCOM will repair it within one year from date of purchase free of charge.
- 3) The following cases will be subject to charge, even during warranty period:
  - a. Breakdown during transport, or through careless treatment, by consumer.
  - b. Breakdown cause by unauthorized repair, or system modification.
  - c. Breakdown caused by natural disaster or power disorder.

**KOCOM CO.,LTD.**

This manual is based on the date as shown in the right and specifications are subject to change without notice for quality improvement.

KDP-603 T0524

# KOCOM

## Interphone for Apartment Unit

KDP-603/603A User's Manual for Operation and Installation

- Interactive call and communication between house and guardroom.
- Communication with lobby phone and door open function.

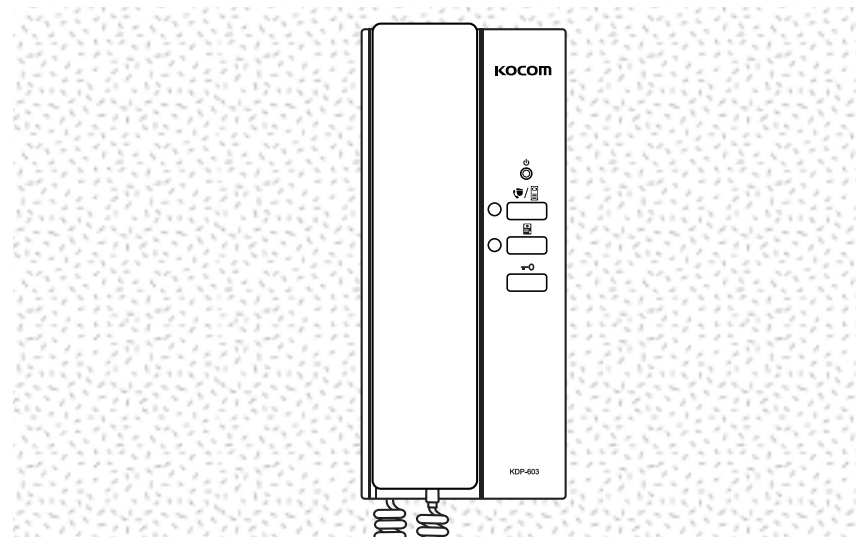

Thank you very much for purchasing KOCOM video doorphone. please read this manual thoroughly to ensure correct usage, before operating.



**KOCOM CO.,LTD.**

# Cautions for Safety







For safe use, please stick to the following cautions.

- Please, save this manual after reading these instructions carefully.
- Read and understand all instructions to set up rightly.
- This Cautions for Safety may include items that are not contained in specifications of the product that consumer purchases.
- If you need assistance with the set-up or operation, please contact with A/S center.

## The important marks in the manual.

To help our customers to understand this manual, to prevent any personal injury or property damage, some marks are used in the manual. The marks and the drawing signs are below. Please, understand the marks before reading the manual.

## The meaning of the drawing signs.

 Sign to show what not to do	 Mishandling the device with ignoring this sign may result in serious injury or death.
 Mishandling the device with ignoring this sign may result physical injury or material damage.	
 Sign to tell you that you should follow the instructions.	 Sing to tell you that you need more attention including high voltages, electric shock, danger, warning)
 Sign to tell you that you can't disassemble this unit.	 Sign to tell you that you must unplug the unit.

## Caution

### Cautions for set-up

- The law limits distributing the power lines to an authorized person from government. The work from an unauthorized person cause fire or electric shock.
- Place this unit securely on a stable surface. Serious damage and/or injury may result if the unit falls.
- Do not set up this unit near the leaking place because it may expose you to dangerous voltages or other risks.
- Even if your product is water proof, do not install it slanted place of water leakage, which can a short circuit.
- Don't put any stuff in 30cm around the monitor, not to block the air hole.

- The work of distributing wires needs skills and experiences. So please, for assistance, contact your dealer or call service center.
- The communication lines should be built in being distant from the power source. This may result in the risk of fire, electric shock and communication disorder.
- Setting the communication lines in a high humid place such as outside without any protection from rain causes the communication disorder.
- Keep the hook at the wall-mounted device safe. The hook may cause the physical injury.
- Think about the thickness and quality of wall material. The unqualified material may make the device fall.

- Set the device of the wall-mounted type not to fall. Falling from an earthquake causes personal injury.

### Cautions for Use

- Do not overload on the device.

### Cautions for Repairs and Maintenance

- Keep the inside of the device clean. Having the dust inside without any cleaning for a long time causes the fire. If necessary, contact your dealer or service center to get cleaning service.
- Unplug this device when you want to check the inside. If there is no plug, please, turn off the circuit breaker.
- Unplug this device when you try to move it to another place. If the electric line is connected inside of the unit, please contact your dealer or service center.
- Do not use liquid or aerosol cleaners. Use a damp cloth for cleaning

## Warning

### Warnings for Usage

- Do not install this unit near the water and dust, for example, in a bathroom or near the washing machine. It caused fire and electric shock.
- Do not install this unit near the fire, for example, near kitchen sink, heater or the like.
- Do not install near the noxious gas such as Hydrogen Sulfide, metal power and the like.
- Do not install near the water and chemicals.
- Do not give any damage, break and modify the plug. Overloading, heating, pulling causes the damage.
- Do not place the plug near the heater. The damaged code causes fire and electric shock. Do not pull the power code when unplugging.
- The damaged code causes fire and electric shock. Must pull with plug. Do not touch with wet hands. It causes the electric shock.
- Do not use any other voltage, except the marked regular voltage.
- Do not use the power terminal at the units to other electric device except the designed device.
- Do not install the units at the leaking place if it doesn't have any waterproof mark. Do not install the unit when the power is on.
- Install the circuit breaker after checking the safety such as electric shock and leakage. Turn off the power before you install or A/S

- Check the suitability of the lines for installing when you use the exiting lines.
- Do the wiring work by using the designed material.
- Connect the electric wire with the designed ways and ground.
- Do not connect with any other devices except the designed devices to compose the system.

- Unplug electric wire and communication lines from the units before moving to another place.

### Cautions for Use

- This unit is not designed for security purpose.
- Do not place a pot with water or a small metal material on the Units.
- Open the main gate after checking ID if the image and sound system do not work. Call A/S
- During thunderstorms, avoid using this unit.
- Do not modify the unit.
- Do not handle the unit with the wet hands.
- Do not cover the ventilating opening or put any metal material in the units.
- There may be a remote risk of an electric shock from lighting.
- Do not disassemble the back and cabinet cover.

### Cautions for Abnormality

- Change the damaged electric code.
- Unplug this unit from plug socket and refer servicing to an authorized service center when the following conditions occur:
  - If liquid has been spilled into the unit.
  - If the unit does not work normally by following the operating instructions.
  - If the unit exhibits a distinct change in performance.
  - If the unit has been dropped or physically damaged.
- The mains plug, as a disconnection device, shall remain readily accessible by the user.

## Caution

### Safety Instructions, Warnings and Cautions of Each System

- Do not disassemble this unit at will as this device is composed by precision parts.
- Install the unit by following the set-up instructions of Kocom.
- Do not touch or insert any foreign substances, for example, sticker, magnetic, opener and the like
- Make U-type at the end of wires as the rain can effect on the system by following the wires during the rainy season.

### VIDEOPHONE

- Separate the AC/DC lines with the hook of the wall-mounted type when installing.
- Do not distribute signal line with AC line.
- Do not clean the LCD with the damp cloth for cleaning. Use the only dry and soft cloth.
- Connect the lines after peeling the wires properly
- Use the designed driver to connect the lines to terminal
- Do not install the main gate monitor at the leaking place.

### Things You Need to Know

- This product is designed as a home VIDEOPHONE and cannot use continuously like monitor camera.
- If there is temperature difference between inner part of camera and surrounding, dew condensation occurs on camera lens and may disturb image. If dew condensation is removed from camera lens, image quality recovers.
- White LED light examination range is narrower than camera shot range at night, so there is less amount of light at night than day. So it is difficult to see the face in low illumination condition due to noise increase on screen, but it is not from defect.
- Monitor screen (liquid crystal panel) is not in defect when some pixels always light or black out.
- Please install monitor and camera over 5cm away. Also, avoid installing at a place with too much noise, because too much noise around camera causes phone call inferiority.
- Do not place an object within 20cm in front of monitor. It causes phone call inferiority, especially because microphone is installed at the top of monitor.
- If strong light such as sunlight flows into camera module, screen saturation (or strange mark) and image shaking might occur. This is not a defect, so please do not install camera where a direct ray of light do not flow if possible.

### Cautions

- In some cases there is occurrence of product destruction, malfunction, noise mixing and picture quality deterioration due to mixing of other tool's induced voltage or thunder with communication wiring of monitor/camera, monitor/extended monitor. Do not wire with power line such as outdoor wiring or AC power, or phones and other tools.
- You cannot use it if you incorrectly wire the AC voltage between monitor/camera, monitor/extended monitor. Call the store or agency where you purchased this product and consult to solve the problem.
- Beware that unfixable damage might be caused due to authorizing AC voltage on communication wiring of monitor/camera, monitor/extended monitor.
- Do not ever disjoint this product. It may cause electrocution accident when touching high-voltage circuit inside this product.
- Outside power authorizing this product must be confirmed of product description and use rated voltage. Beware that if higher voltage is authorized, unfixable damage might be caused due to product destruction.
- Power must be connected to domestic voltage (product rated voltage) consent or interior wiring.
- If connected to other motive power or inverter-type power, product destruction, noise mixing, and picture distortion may occur.
- Do not drop this product. Glass is used for monitor and might break, or cause other circuit inferiority.
- In such case, immediately turn down the power switch, and call to consult agency or store in which this product was purchased.
- If installed near transmission antenna such as broadcasting station, electric wave may mix and cause picture distortion or voice mixing.
- Avoid installing near tools with strong electromagnetic waves such as microwaves and cell phones, or it may cause picture distortion.
- Do not install monitor in following places.
  - ①Above or around water heater, rice-cooker, heater
  - ②Place exposed to direct rays of the sun
  - ③Place with temperature below 0°C such as cold store
  - ④Place with high humidity such as bathroom, washroom, heated room
  - ⑤Place with a lot of gas, dust, smoke
  - ⑥Dangerous place with sprays of water or chemicals
- Do not wipe with insecticide, drugs or chemicals such as thinner and alcohol, or it may damage the surface of this product.
- Beware of occurrence of image quality deterioration or malfunction from cause of humidity due to penetration of chemicals or water into camera's urea resins.
- As in the picture, it prevents temperature difference of camera (outside) and monitor (inside), and removes dew condensation caused by humidity of camera window.
- Camera must be installed when wall cement is completely dry.
- When product is installed in winter below -5°C, wait for approximately 2 hours to connect. Dew formation in monitor and camera due to temperature difference inside and outside may cause product defect.
- Avoid installing monitor and camera in place directly exposed to heat or where gas noxiousness is highly occurring.

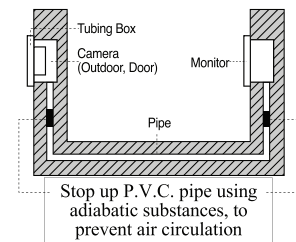

## Precautions for Operation

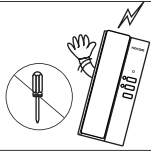

As this device consists of electronic precision components, do not attempt to disassemble.

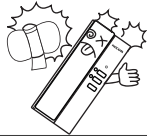

Do not drop this device and avoid strong impact.



Keep away from humidifier and stove. High temperature and humidity may cause troubles.



When cleaning, do not use wet hand, volatile benzene or paint thinner. Use soft cloths dipping in neutral detergent to wash this device and dry it with dry clothes.



Clean the exterior of this device with soft cloths at times to keep it in clean state.

## Component's Name

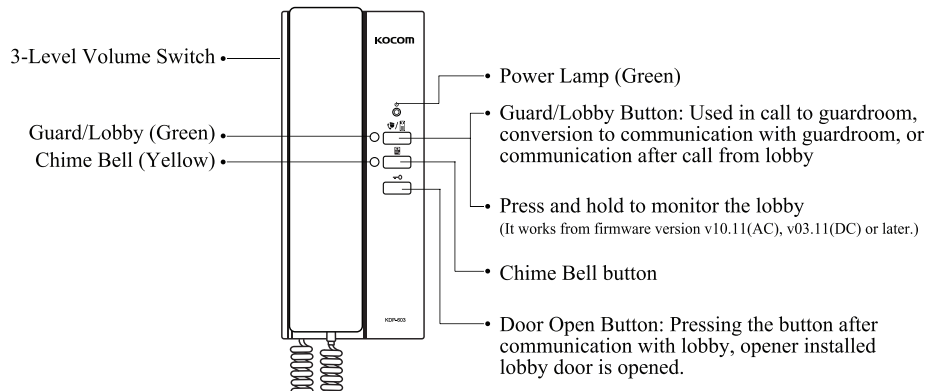

## Instructions for Installation

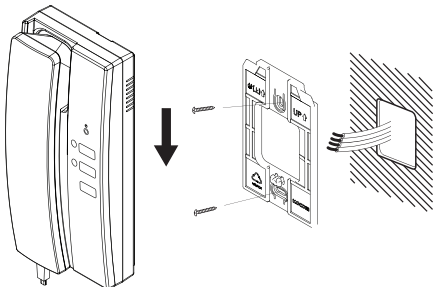

Place bracket on the wall and fix it with screws. After wiring, fit the rear side of main frame to a groove in the bracket and pull the main frame down to fix.

## External Wiring Diagram

### WIRING

POWER LINE : IV 1.2Ø  
VOICE/DATA : IV 0.8Ø  
DOOR VOICE : IV 0.65Ø

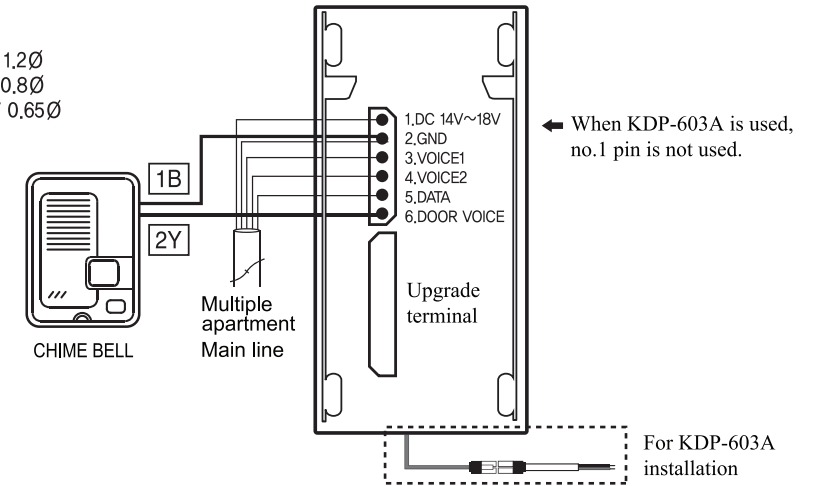

### Precautions for Wiring

- As incorrect wiring may cause the device's non-operation or poor communication quality, please carefully conduct wiring work.
- When connecting a wiring chord to a terminal, loosen screw, insert the end of the chord into the bottom part of screw, and tighten the screw.
- When fixing wiring chord, use stapler not to cause damage to the chord.
- When using existing wiring, please be cautious not to cause disconnection and short-circuit.

## Product Specification

	KDP-603	KDP-603A
<b>Power</b>	DC 14V~18V	AC220V~, 60Hz
<b>Consuming Electricity</b>	Max 1W (standby mode) / Max 3W (operation mode)	Max 1.5W (standby mode) / Max 5W (operation mode)
<b>Guaranteed Operation Temperature</b>	0°C ~ 50°C	
<b>Communication Mechanism</b>	Balance Circuit DUPLEX HANDSET CONVERSION	
<b>Melody</b>	front door, inner lines, guardroom, lobby	
<b>Wiring</b>	5-line polar wiring ( VCC/GNDVoice 1/Voice 2/DATA ) ( OPTION : Chime SW 2Line(signal / GND ) )	
<b>Wiring Distance</b>	Power(+/GND) 1.2 Ø 300M with in ( OPTION : ChimeSW - Ø 0.5 SINGLE CABLE / with in 50m)	
<b>Dimensions</b>	92(W) x 210(H) x 57(D) mm	

## Wiring Specification

- 5-line polar wiring between wirings in main line of apartment unit
- 6-line polar wiring between KVM-520, KIV-102, KIV-212, KCV-802R (monitor) and interphone
- 2-line non-polar wiring in connection with chime switch at front door
- 6-line polar wiring when installing more devices

## Functional Specification

- Pressing chime switch to call, chime tone of call from front door rings (device does not support communication function and only detects call state).
- Inner line call and communication - chime tone of inner line call rings and communication maintains for 3 minutes (installation of additional monitors and interphones is required).
- Communication with lobby phone - After chime tone rings, user can communicate with lobby phone for 3 minutes. (If pressing the door open button during the communication with lobby phone, opener installed common lobby door is opened.)
- Call to and communication with guardroom  
If pressing guard button on interphone, user can call to and communicate with guardroom.

## Operational Description

### ■ Call from lobby

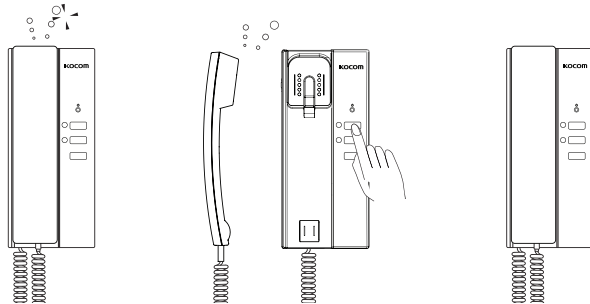

- When a lobby calls to house in standby mode, tone sound rings for about 30 seconds in house.
- Speaker outputs tone sound and (lobby/guard) LED flickers.
- Picking up handset, communication with lobby is automatically available (available communication time: 3 minutes) (At this time, LED is turned off.)
- To open the door during the communication with lobby, press door open button and opener will automatically operate.
- Hang up handset, communication is ended (call to lobby function is not available).

## Call to guardroom for communication

- If picking up handset and pressing guard/lobby button, guardroom is called out (call maintains for 30 seconds).  
(When other house is not on the line, LED is turned on.)
- If guardroom responds to the call, call state is maintained (for 3 minutes).  
(When communication begins, LED is turned off.)

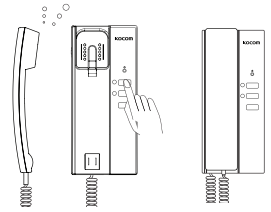

## Call from guardroom to house

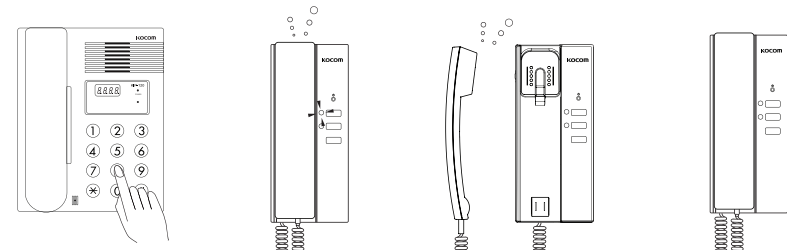

- If guardroom calls to house, tone sound rings in handset of house (for 30 seconds) and (guard/lobby) LED flickers. Picking up handset, communication begins (communication maintains for 3 minutes).
- At this time, LED is turned off.
- Hanging up handset, communication is automatically ended.

## Instructions for Operation

### ■ Instructions for Operation

**Model: (KDP-100 / KLP-100 / KLP-P100 / KLP-C100), Functional Specifications**

#### ▷ Call to house

When a visitor calls to house using lobby phone, press house number.

e.g) In case of calling to house No.101

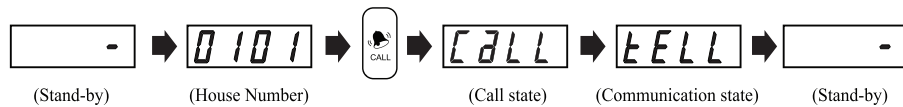

> Pressing call button, call sound rings and house is called.

> If the house responds to the call, communication is available for 3 minutes.

(Pressing door open button during the communication, opener installed with common gate is opened.)

> When communication is ended, device returns to standby mode.

#### ▷ Call from lobby phone to guardroom

Pressing “0” and call button on the lobby phone, guardroom is called and lobby phone ID is displayed in guardroom phone.

> Communication with guardroom maintains (for 3 minutes). When communication is ended,

device returns to standby mode.

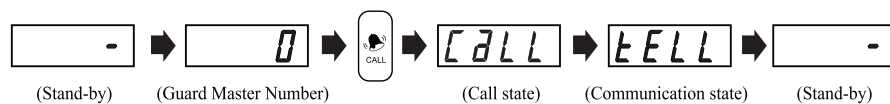

#### ▷ Password Change

(Password change function is only available during the call with house.)

Pressing “##00#” during the call with house, “- - - -” is displayed.

Input new password and press “#” button.

e.g) When register password as ‘1111’. (It should be 4 digits)



#### ▷ Door open using lobby phone with password

Pressing “house number + # + password + #” designated by the house, door is automatically opened.

when the user from house number “0101” opens common gate with password.

e.g) Press house number “0101”, #, password and # in order.

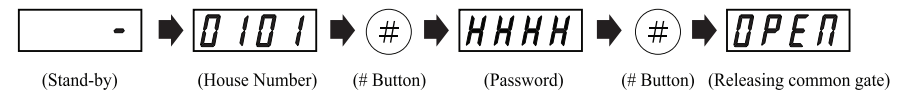

### [Lobby Phone's Direct-Button Call Function]

**Model : KDP-104, KDP-108, KDP-112, KLP-104, 108, 112, KLP-P104, P108, P112,**

**KLP-C104, C108, C112**

**To call to house, press house number using lobby phone's key pad.**

Tone sound rings and call signal is sent to the house.

Pressing the call button again while calling, calling is cancelled. No separate cancel button is offered.

If called house is communicating with extended other lobby phones or guardroom phone,

busy signal sounds and device immediately returns to stand-by mode.

### ▷ Operation of Door Opener While Communicating with House

1. Pressing door open button during the communication with house, common gate is opened.

(Door Opener Specification: Within DC 12V 300mA)

※ Functional specifications may be changed according to the specifications of installed products.

## DIP Switch Setting at House Interphone and Video Phone

■OLD MODE : It is compatible with the existing units. ID is available with 1~63, 1000~1963, 2000~2963, 3000~3963.

※ There should be no mixed protocol in a system. Mixed protocol in a system can make the malfunction of system.

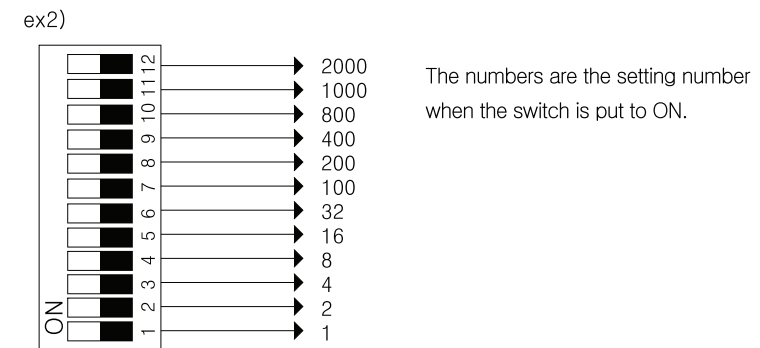
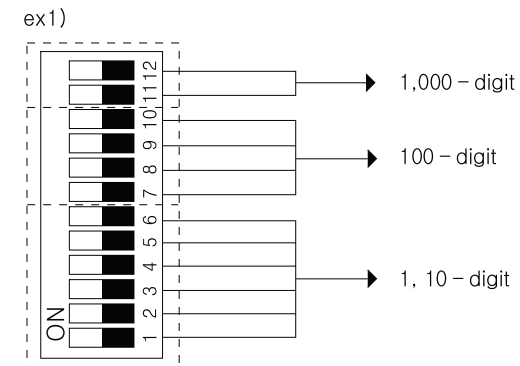

1. If DIP SWITCH from 1 to 12 is put to ON, the numbers of DIP SWITCH will be summed up.

ex1) If the switches 1 and 2 are put to ON, the setting number becomes  $1+2=3$ .

ex2) If the switches 1 and 3 are put to ON, the setting number becomes  $1+4=5$ .

ex3)

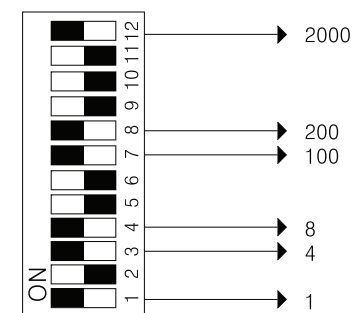

In this case, DIP SWITCH 1, 3, 4, 7, 8, 12 is put to ON, the result is  $1+4+8+100+200+2,000=2313$ , the house No.2313

ex4)

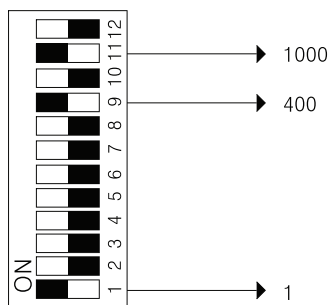

In this case, DIP SWITCH 1, 9, 11, 12 is put to ON, the result is  $1+400+1000=1401$ , the house No.1401

ex5)

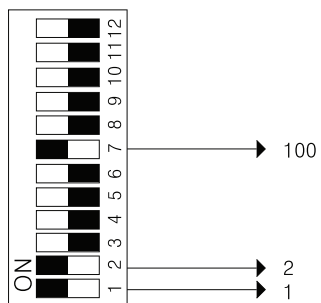

In this case, DIP SWITCH 1, 2, 7 is put to ON, the result is  $1+2+100=103$ , the house No.103

ex6)

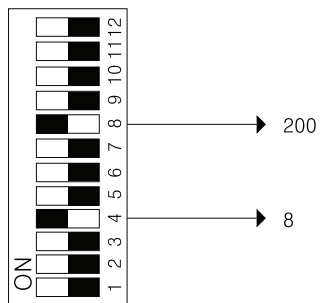

In this case, DIP SWITCH 4, 8 is put to ON, the result is  $8+200=208$ , the house No.208

ex7)

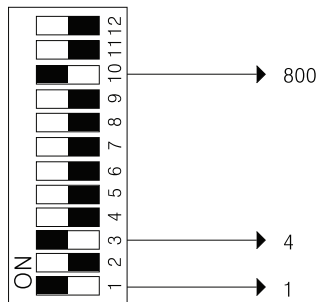

In this case, DIP SWITCH 1, 3, 10 is put to ON, the result is  $1+4+800=805$ , the house No.805

ex8)

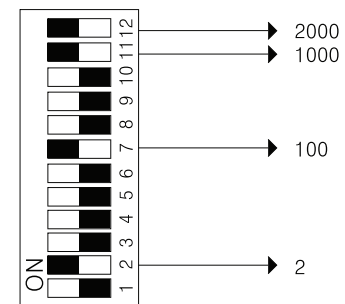

In this case, DIP SWITCH 2, 7, 11, 12 is put to ON, the result is  $2+100+1000+2000=3102$ , the house No.3102

ex9)

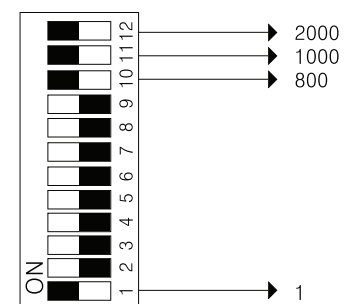

In this case, DIP SWITCH 1, 10, 11, 12 is put to ON, the result is  $1+800+1000+2000=3801$ , the house No.3801

ex10)

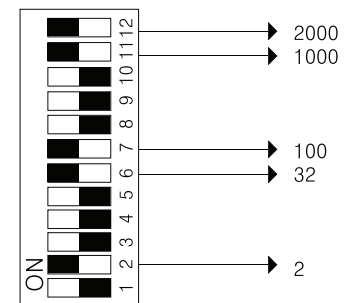

In this case, DIP SWITCH 2, 6, 7, 11, 12 is put to ON, the result is  $2+32+100+1000+2000=3134$ , the house No.3134



## 2. Precautions for DIP Switch Setting (House No. Setting)

1) After setting DIP switches, device power should be reset.

(In power switch ON state, DIP switches cannot be set.)

2) For direct button type lobby phone, up to 12 houses can be set.

Thus, when DIP switches of house interphone and video phone are set, available houses are also 1 to 12 in number.

For Common gate pannel (KDP-104/KDP-108/KDP-112) and Lobby Phone (KLP-104/KLP-108/KLP-112, KLP-C104/KLP-C108/KLP-C112, KLP-P104/KLP-P108/KLP-P112), house (KVM-520 and KIP-603, KIV-102, KIV-D102, KIV-212, KIV-D212, KCV-802R, KCV-D802R) No. setting should be conducted as following instructions. (A specification preset by internal protocol)

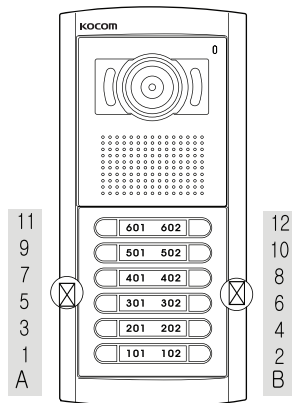

### House No. (DIP Switch) Setting for direct button type.

House Setting No.

	Lobby Phone (Column A)	Lobby phone (Column B)	Household monitor setting number
KDP-104	1 (101)		1
KLP-104		2 (102)	2
KLP-P104	3 (201)		3
KLP-C104		4 (202)	4
KDP-108	5 (301)		5
KLP-108		6 (302)	6
KLP-P108	7 (401)		7
KLP-C108		8 (402)	8
KDP-112	9 (501)		9
KLP-112		10 (502)	10
KLP-P112	11 (601)		11
KLP-C112		12 (602)	12

(Warning!) House device should be set as described above (Fix house No. type).

3) If user wants to use interphone or video phone as sub-phone, all DIP switches should be in OFF state.

4) When user sets DIP switches, excessive impact on DIP switches may cause abnormal or erroneous operation of device.

## DIP Switch Setting at House Interphone and Video Phone

■ NEW MODE : It is available to set from No. 1~1599.

1) DIP SW 1~4, it is available by 15, the sum of 1248. In case of 2 digits from 9 are available by No.9. And 10~15(A~F HEX code)'s setting is 9.

2) DIP SW 5~8 is available by 15, the sum of 1248. In case of 2 digits from 9 are available by No.9. And 10~15(A~F HEX code)'s setting is 9.

3) DIP SW 9~12 is available by 15, the sum of 1248.

※ There should be no mixed protocol in a system. Mixed protocol in a system can make the malfunction of system.

※ KIP-120 and KLP-100 Series only matching with over 4.0 version's NEW MODE.

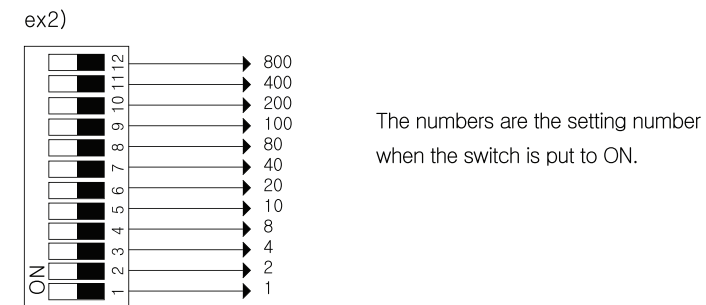
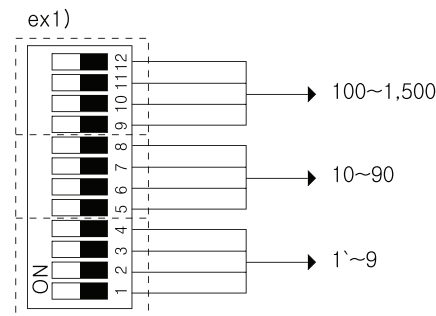

1. If DIP SWITCH from 1 to 12 is put to ON, the numbers of DIP SWITCH will be summed up.

ex1) If the switches 1 and 2 are put to ON, the setting number becomes 1+2=3.

ex2) If the switches 1 and 3 are put to ON, the setting number becomes 1+4=5.



ex3) To set the house No.999

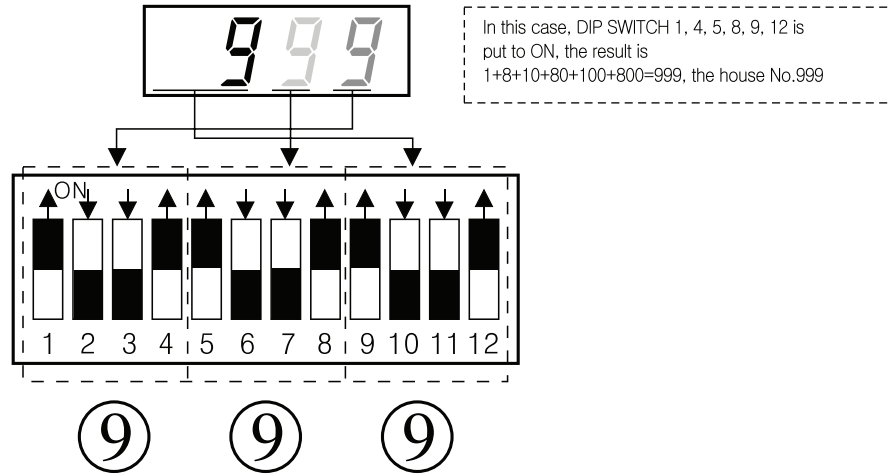

ex4) To set the house No.1203

